

19 February 2010

Dear Resident or Business Occupier



### Haymarket Update

We are writing to update you on forthcoming tram work in the Haymarket area. In February the following worksite locations and traffic management changes will be in place.

Site	Start Date	Location	Description	Duration
1	Saturday, 6 February	Both sides of West Maitland Street between Grosvenor Street and Palmerston Place	<ul style="list-style-type: none"><li>• Eastbound traffic will be maintained</li><li>• Business loading provisions will be maintained</li><li>• A pedestrian crossing will be maintained at the Palmerston Place end of the site</li></ul>	Mid April
2	Saturday, 27 February	West Maitland Street between Palmerston Place and Atholl Crescent	<ul style="list-style-type: none"><li>• A single lane of eastbound traffic will be maintained</li><li>• Westbound buses will be diverted via Lothian Road and the West Approach Road</li><li>• Shandwick Place bus stops will be re-located on the West Approach Road, near Lothian Road, and Morrison Link</li><li>• Manor Place will be <b>closed</b> to traffic at the Shandwick Place junction</li><li>• Access to Manor Place will be maintained via Drumsheugh Gardens and Melville Street</li><li>• A pedestrian crossing will be maintained near Manor Place junction</li><li>• Torphichen Street and Palmerston Place will both re-open to traffic at their junctions with West Maitland Street</li></ul>	Mid April

Eastbound buses will remain diverted via Rosebery Crescent and Grosvenor Street for the foreseeable future, however, this will be continually monitored.

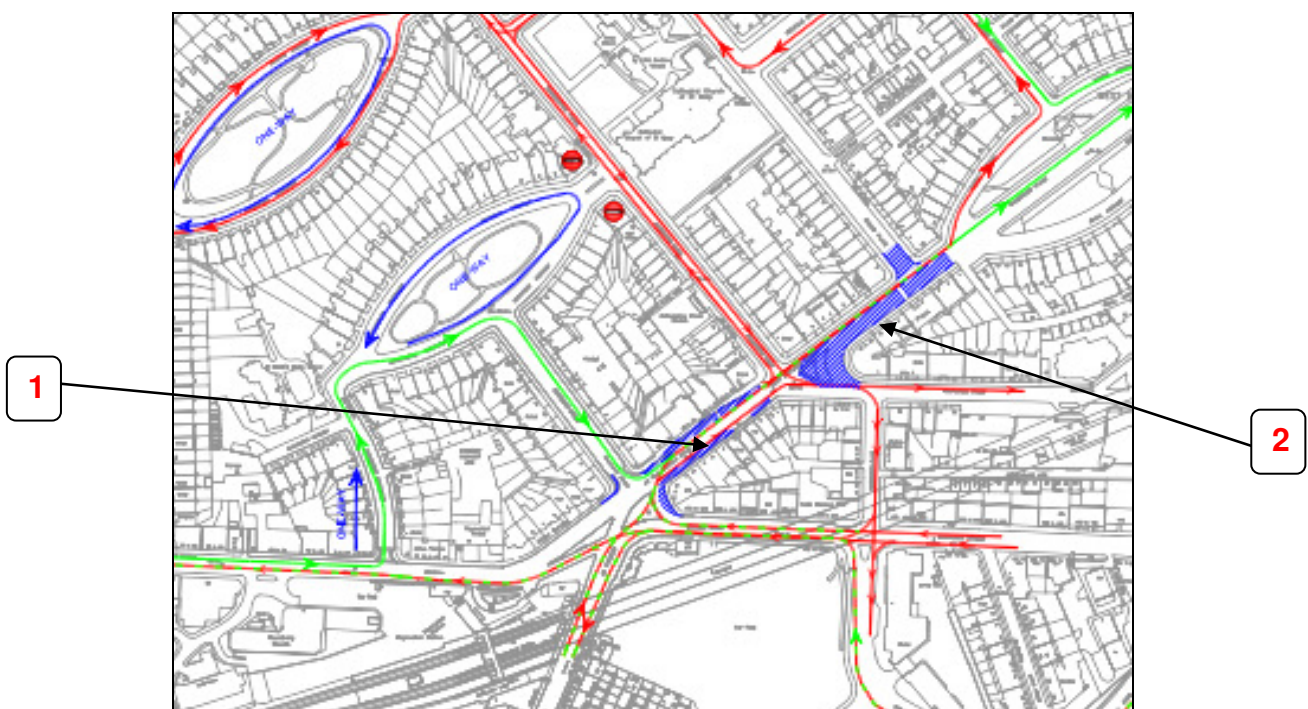

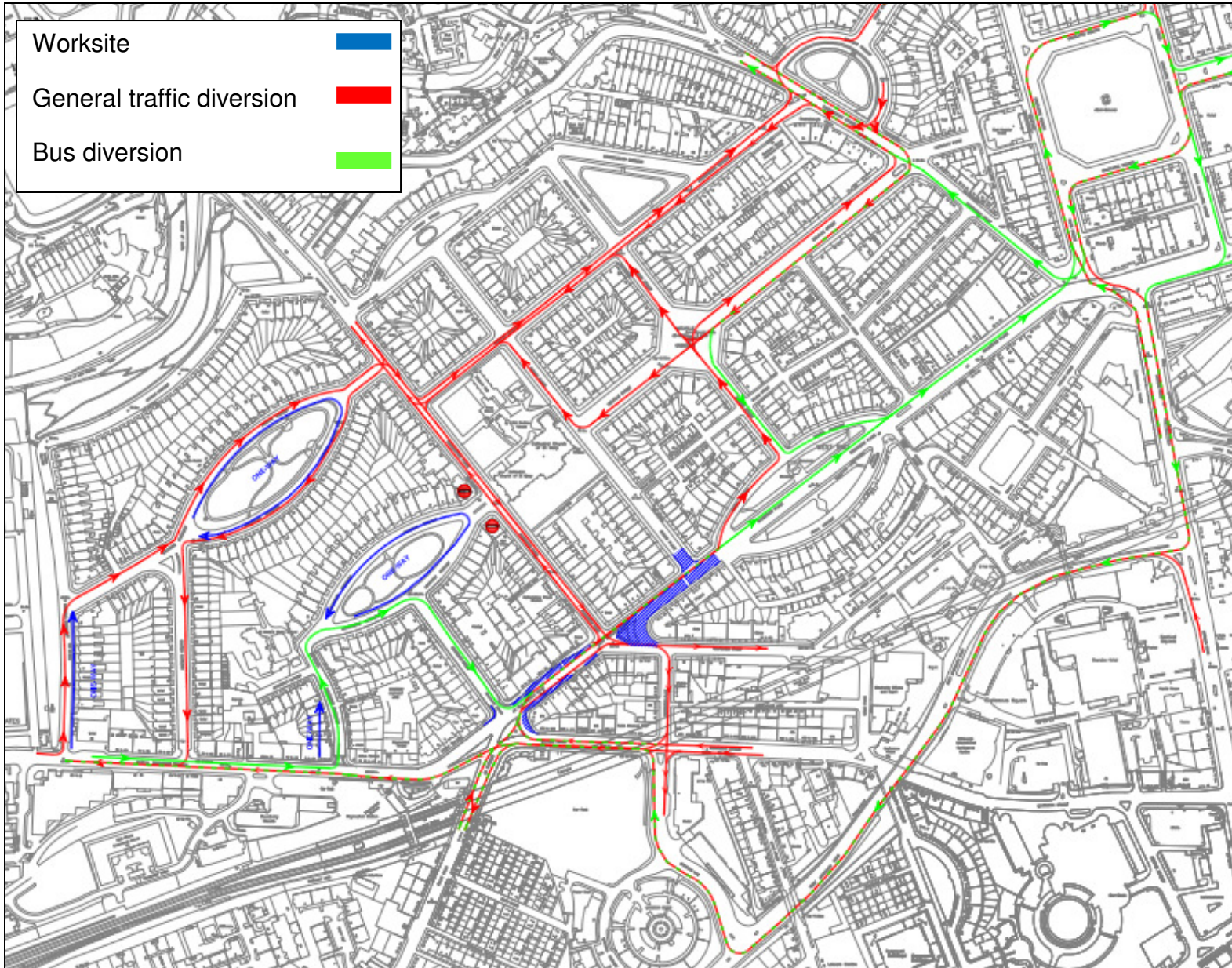

For more information about our works visit

[www.edinburghtrams.com](http://www.edinburghtrams.com) and click on **My Local Updates**

Alternatively, you can call our Customer Helpline on 0800 328 3934 or email

[info@edinburghtrams.com](mailto:info@edinburghtrams.com)

Yours faithfully



Steven Bell  
Tram Project Director

Find out more about  
Edinburgh Trams online

